

PURPOSE-BUILT MINING EQUIPMENT



GETMAN SERVICE MACHINES are designed to help perform key maintenance and repair functions throughout an underground mining operation, minimizing the need to return other production and production support equipment to the workshop and maximizing the time those machines spend in their production and development roles.

The Getman A64 Fuel Service Machine includes a single 2000 gal (7571 L) tank for refueling operations

underground, and includes internal tank baffling for improved performance during tramming. The high-rate delivery service includes a delivery line and nozzle mounted on a spring return reel for improved operation.

A64 service equipment protects worker safety through purpose-built design, including outward facing sight gauges visible from ground level, minimizing the need to climb on the machine. All work areas are well-illuminated to ensure proper visibility during servicing functions.



TECHNICAL SPECIFICATIONS

ENGINE

- Stage V/ T4F Approved Cummins B 4.5 - 129kW (173 hp)
- Tier III approved engine (4 cylinder)
 - › Cummins QSB4.5, 127kW (170hp)
- Liquid-cooled, turbocharged
- 113 L (30 gal) fuel tank with self-closing cap
- Ansul LVS FSS, tied to engine shutdown

EXHAUST SYSTEM

- Exhaust after-treatment

TRANSMISSION

- Dana Clark powershift transmission
- Three speeds forward and reverse
- 4-wheel drive

AXLES

- Planetary drive axles
 - › Kessler S72 higher capacity axle package

TIRES

- Mine service tires
 - › 12.00x20

BRAKE SYSTEM

- Service brakes are spring-applied, hydraulic-released, liquid-cooled multi-disc brakes on all wheels.
- Automatic brake application (ABA) occurs upon fire suppression activation or loss of hydraulic accumulator pressure, transmission pressure or electrical power

STEERING

- Orbitrol controlled articulated frame steering
- Heavy-duty, self-aligning bearings inside replaceable inserts
- Two double-acting steer cylinders with replaceable bushings in cylinder and frame ears

HYDRAULIC SYSTEM

- Hot side/cold side engine layout
- Hydraulic hoses routed to cold side of engine
- Open or closed center hydraulic circuits
- Diagnostic test ports with quick couple fittings for: each axle, service and park brake pressure, and hydraulic pumps
- 10-micron return filter
- 151 L (40 gal) hydraulic reservoir

OPERATOR COMPARTMENT

- Three-point contact for entry and exit
- ROPS/FOPS certified canopy
 - › Open cabin
 - › Enclosed cabin with HVAC
- Operator + passenger seating
- Mechanical suspension operator seat
- Retractable lap seat belts

INSTRUMENTATION

- Engine coolant temperature
- Voltmeter
- Hour Meter
- Tachometer
- Transmission charge pressure
- Transmission oil temperature
- Brake accumulator pressure gauge
- Brake accumulator low-pressure warning
- Park brake applied indicator light
- Audio/visual alert for high engine temperature
- Visual alert for low engine oil pressure
- Transmission hours
- Transmission neutralizer
- Audio/visual alert for low hydraulic tank level
- Visual alert Engine ECM

ELECTRICAL SYSTEM

- 24 V electrical system
- Lockable master switch (isolator)
- Maintenance-free batteries
- LED lighting package (IP69K rated)
- Sealed connectors
- Braided outer jacket harness protection

OTHER GENERAL EQUIPMENT

- Variable audio backup alarm (87-112dBA)
- 2x 10 lb fire extinguisher
- Wheel chocks
- Manual actuated Ansul LVS FSS tied to engine shutdown

OPTIONAL EQUIPMENT

- Wiggins fill system
- Brake Cooling Package
- Lincoln auto-lubrication package
- Ansul Checkfire automatic actuation fire suppression system with linear detection loop
- Door and/or seat belt interlocks

FLUIDS DELIVERY SYSTEM*

SERVICE TANK SETUP

- 7571 L (2000 gal) tank
- Service tank is supplied with dual fill points, breather/check valves and sight glasses
- Services pumped by hydraulic powered delivery pumps with built-in relief valves.
- Equipped with 'y' strainers and shutoff ball valves for servicing.
- Services actuated by selector valve or push-button keypad on SE models.
- Fluid service is equipped with hose and nozzle on spring return reel
- Hose and reel delivery system with 15 m (50 ft) hose for fluid service
 - › Diesel fuel delivery service: 37.9 lpm (10 gpm)
 - › Diesel fuel delivery service: 75.7 lpm (20 gpm) *optional
 - › Diesel fuel delivery service: 189.3 lpm (50 gpm) *optional

SERVICE TANK OPTIONS

- Service tank filled through wiggins receiver
- Diesel Delivery Meter, up to 208 lpm (55 gpm), Metric units
- Wiggins delivery nozzle on diesel service

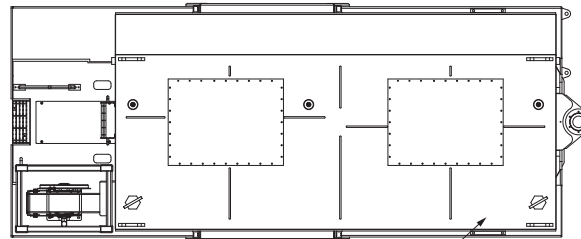

7571 L [2000 GAL]
TANK CONFIGURATION

SE (SIDE ENTRY) UPGRADE

- 2-door, side entry, cabin
- Optional enclosed pressurized cab with cabin filter
- Optional HEPA cabin filter
- Forward & side facing swivel driver seat with armrests, mechanical suspension
- Two sets of pedals
- Joystick steering control
- Distributed Control electrical system
- Enhanced interactive display with a large-format screen
- Vehicle performance monitoring with on-screen gauges and diagnostics



DESIGN FEATURES AND LAYOUT

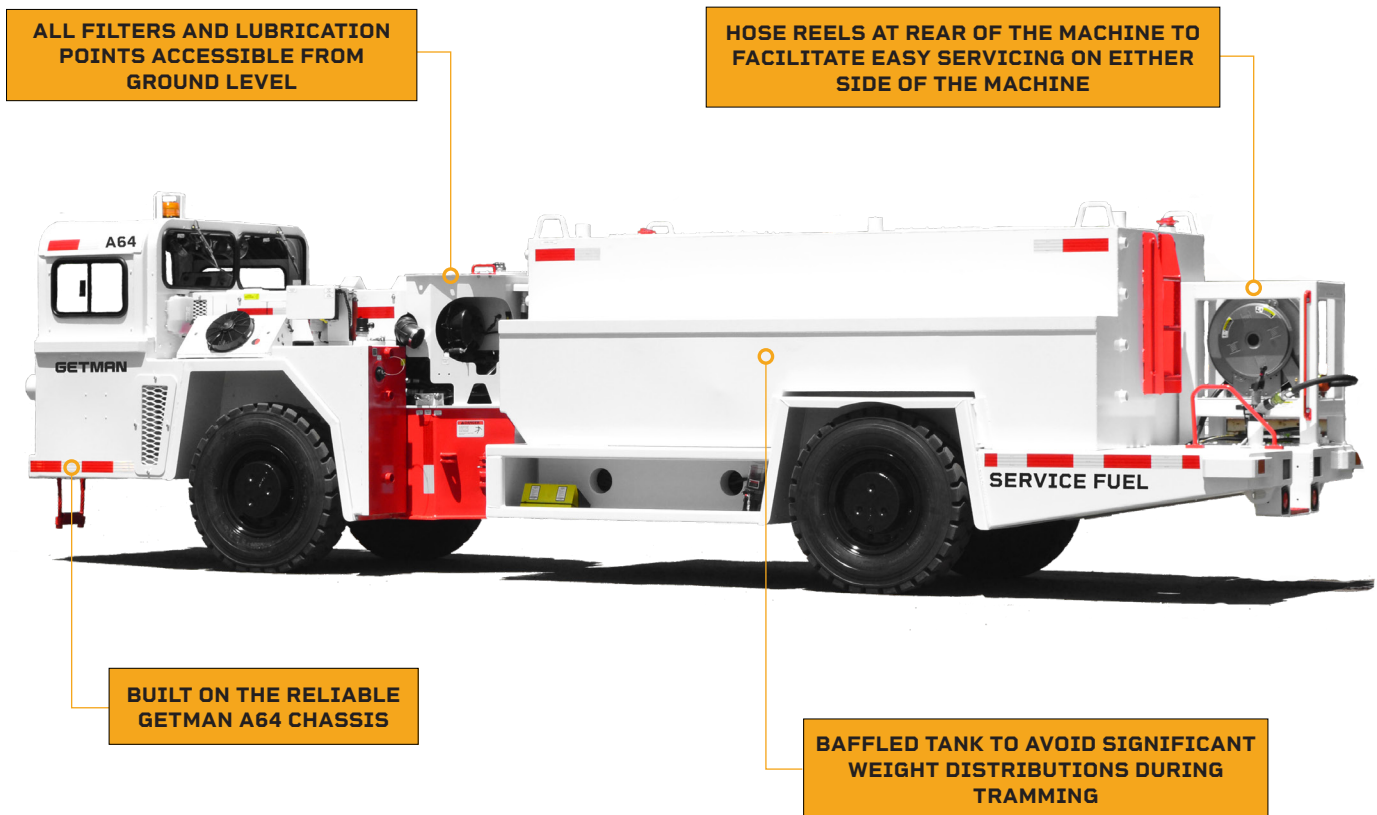

DIMENSIONS AND MANEUVERABILITY

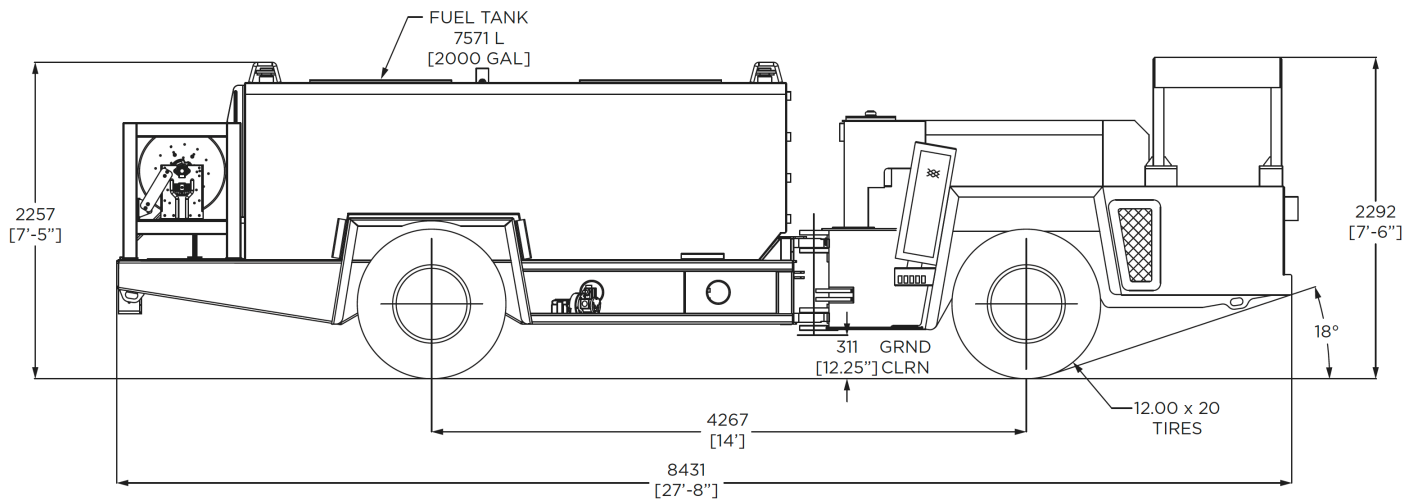

MACHINE LENGTH	7215 mm	284 in
WHEELBASE LENGTH	3658 mm	144 in
GROUND CLEARANCE	311 mm	12.25 in
MACHINE HEIGHT	2292 mm	90 in

DIMENSIONS AND MANEUVERABILITY

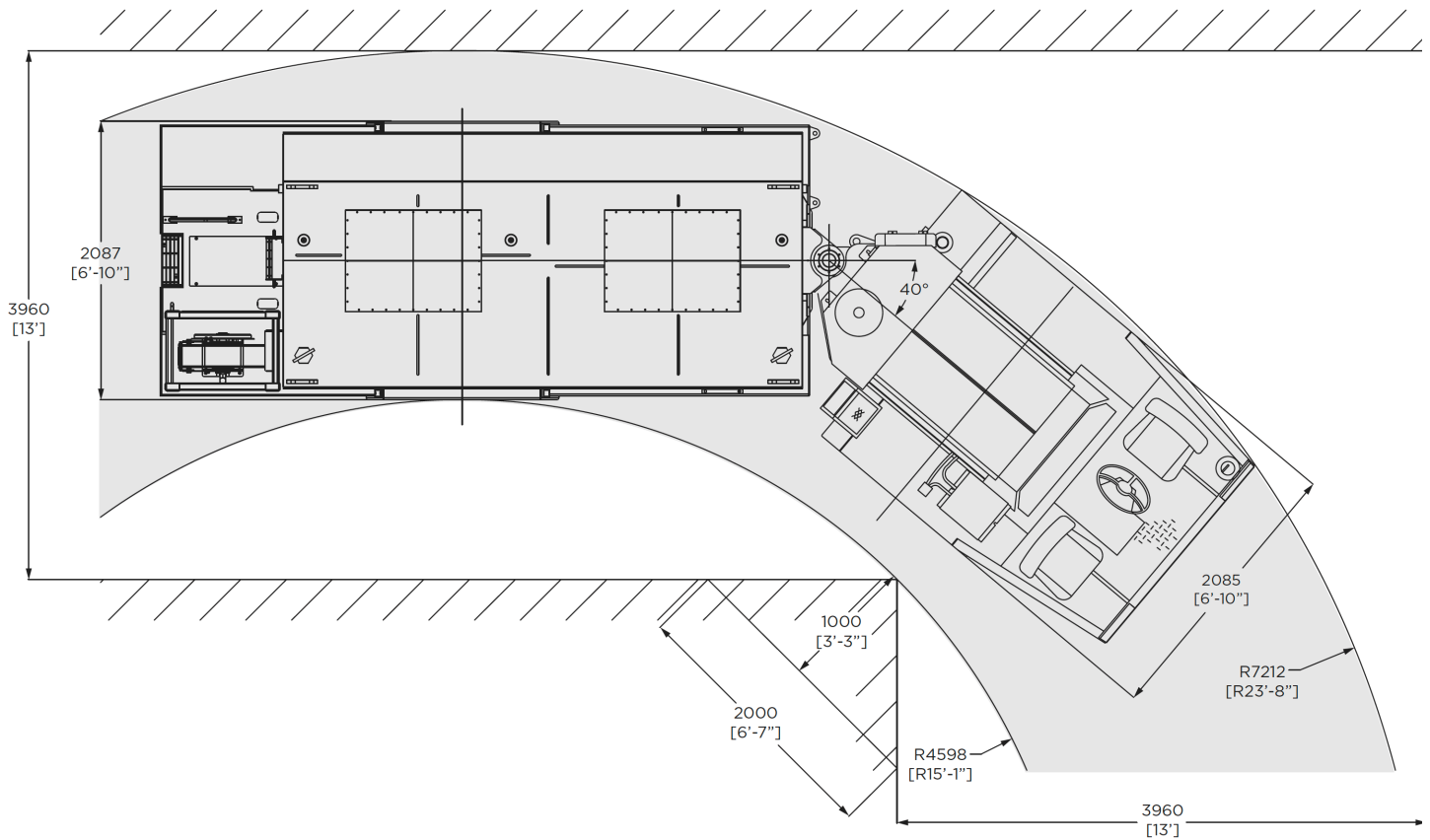

MACHINE WIDTH	2083 mm	82 in
INNER TURNING RADIUS	3873 mm	152 in
OUTER TURNING RADIUS	6297 mm	248 in

ENGINE AND PERFORMANCE

CUMMINS QSB4.5 ENGINE PACKAGE

MANUFACTURER	Cummins
MODEL	QSB4.5
STAGE	Tier III
DESIGN	4 Cylinders in line, water cooled
MAX POWER	127 kW (170 hp) @ 2200 rpm
EXHAUST SYSTEM	Catalytic exhaust conditioner and silencer
ASPIRATION	Turbocharged
FUEL CONSUMPTION	243 g/kW-hr (0.399 lb/hp-hr)

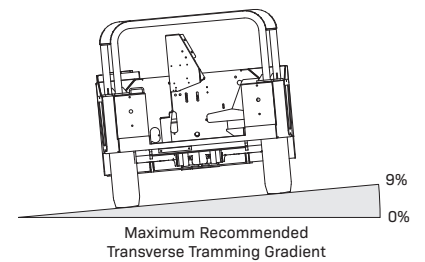
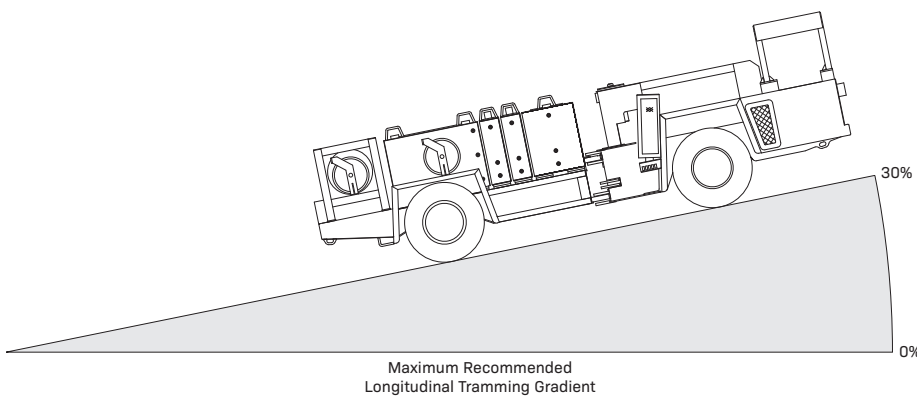
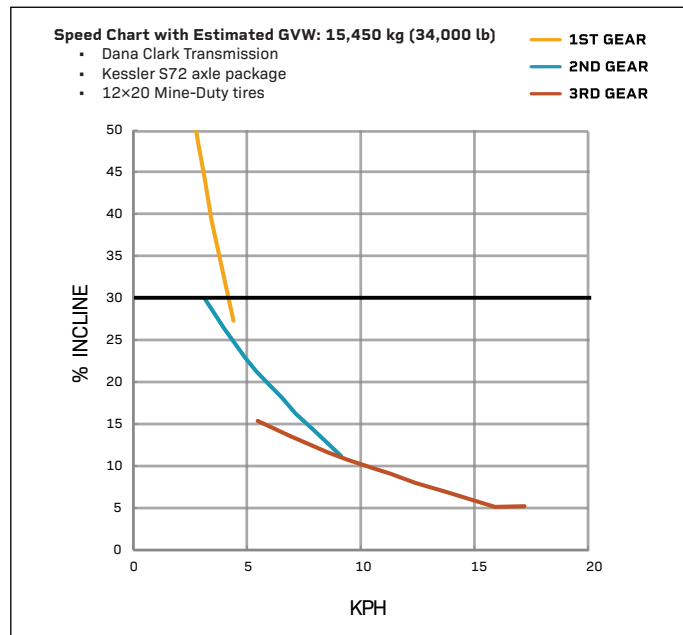



ABOUT GETMAN CORPORATION

Getman Corporation is a global supplier of mobile equipment to the mining industry, offering customer-specific solutions to underground mines in the production and production support classes of equipment. All Getman equipment is designed with extensive research and development and is supported by over seventy years of experience in serving the underground mining industry.

Through our network of distributors we sell and support our products on six continents, offering exceptional product solutions and following up with world class aftermarket support. At Getman Corporation, designing and building vehicles for the underground mining industry is what we do. We take pride in being the preferred supplier of underground production and

production support equipment to miners globally by offering customer-specific, value-driven and long-lasting solutions. For more information contact your Getman distributor or email us at info@getman.com, or visit our website at getman.com.

For parts or service support, email us at parts@getman.com or service@getman.com.

Getman Corporation assembled this datasheet with the intention of passing along the most accurate information possible, however this document shall not be binding in any way and shall be considered informational only. All values stated herein are theoretical in nature. All orders are accepted based on the terms and conditions set forth in the individual purchase or sales agreement. Getman reserves the right to make changes to the specification herein at any time and without further notification.

Pictured machines in this document may contain optional and additional equipment.

GETMAN

GETMAN CORPORATION
59750 34th Avenue
Bangor, MI 49013 USA

Tel +1 (269) 427-5611
info@getman.com
getman.com